

## IntaKlean Nano IKN34 Installation & Servicing Instructions

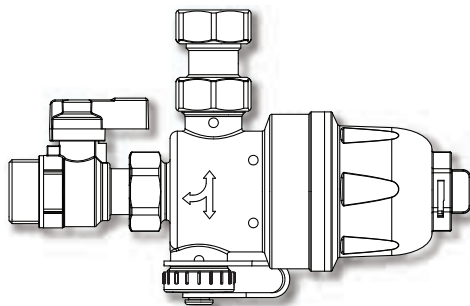

# inta

**Intatec Ltd**

Airfield Industrial Estate  
Hixon  
Staffordshire  
ST18 0PF

In this procedure document we have endeavoured to make the information as accurate as possible.

We cannot accept any responsibility should it be found that in any respect the information is inaccurate or incomplete or becomes so as a result of further developments or otherwise.

Tel: **01889 272 180**

Fax: **01889 272 181**

email: **sales@intatec.co.uk**

web: **www.intatec.co.uk**

## LOCATION

The IntaKlean Nano is a magnetic system filter designed to remove ferrous and non ferrous material from fluid systems.

IKN34 has been specifically designed to be installed directly underneath the relevant heat source such as boilers, heaters and Heat Interface Units.

For maximum system component protection we advise that the IntaKlean Nano is installed onto the return leg of the circuit, between the last radiator and the boiler.

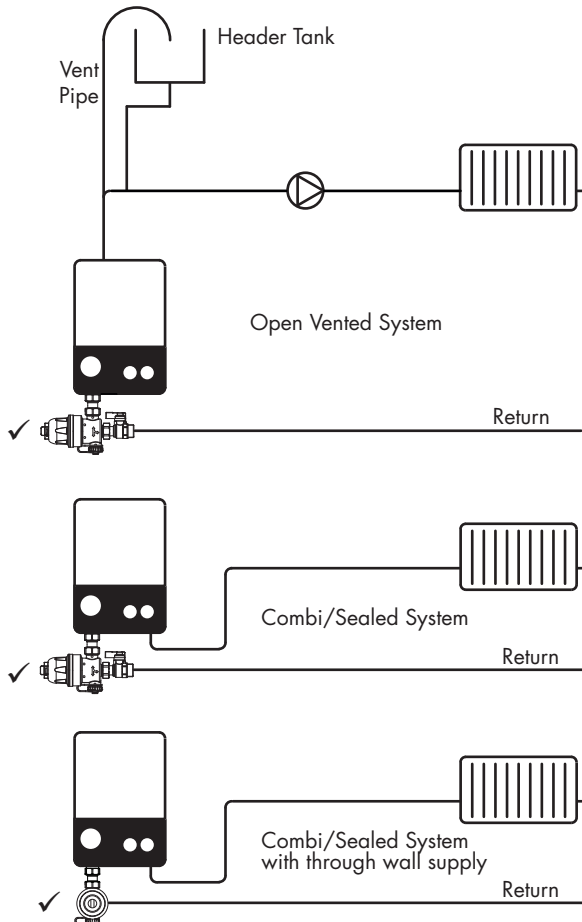

## LOCATION

The IntaKlean Nano can be configured to suit site conditions with the position of the ball valve, connector and drain utilising any of the 3 connections on the filter pot.

Ensure that the system is drained down and all system pressure has been released.

On open vented systems, make sure that the feed and expansion tank is isolated.

When siting the IntaKlean Nano magnetic system filter, great care should be taken to place the filter so that access for the removable magnetic probe and drain plug is available. Doing this will aid the servicing of the filter and any chemical dosing in the future.

## COMPONENTS

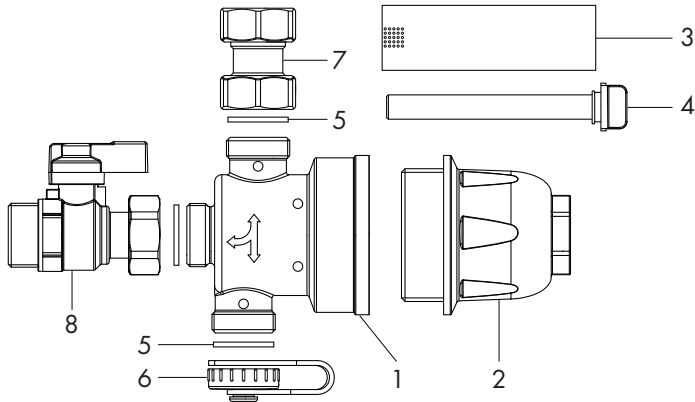

| Item | Qty | Component                        |
|------|-----|----------------------------------|
| 1    | 1   | Filter pot                       |
| 2    | 1   | Transparent cap                  |
| 3    | 1   | Filter cartridge                 |
| 4    | 1   | Magnet                           |
| 5    | 3   | Sealing washer                   |
| 6    | 1   | Drain cap and strap              |
| 7    | 1   | Connector                        |
| 8    | 1   | Ball valve with union connection |

## INSTALLATION

If an existing system, drain the heating system and locate the return pipe where the IntaKlean Nano will be located.

If a new system locate the return pipe.

The whole system should be thoroughly flushed, prior to fitting the IntaKlean Nano, to remove any debris that may be in the supply pipework.

Installation steps:

1. Assemble the isolating valve, connector and blanking cap onto the filter body using the sealing washers provided and tighten.
2. The IntaKlean Nano will connect directly to the heating return on the boiler and the pipework can be configured to suit one of the configurations shown in the Location Diagram on page 2.
3. Offer the assembly up to the in place pipework connections, tighten accordingly.
4. Fill the system with fluid with the isolating valve closed.
5. Open the ball valves and allow the system to fill, check all joints for leakage.

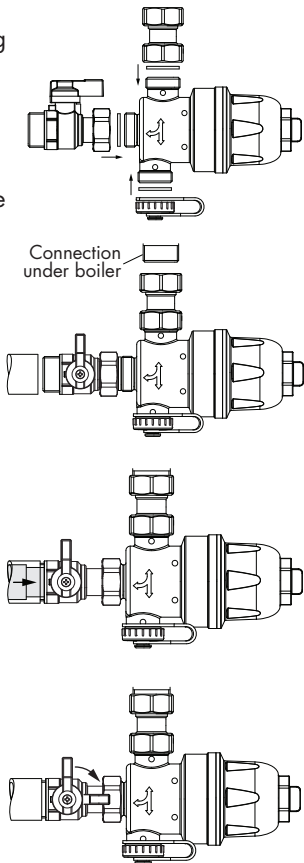

## DIMENSIONS

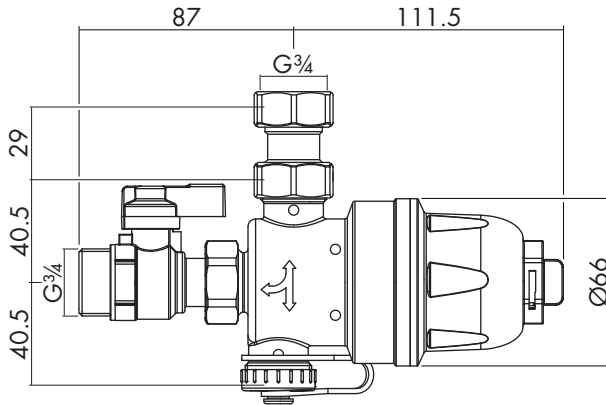

## COMMISSIONING

The commissioning procedure should be carried out as follows;

- 1 Making sure that all open ends of the system are closed, begin to refill the system.
- 2 Bleed radiators as required.
- 3 Open any manual air vents installed in the system to release any trapped air.

**N.B.** – Air may continue to be present in system pipework for a small period as the central heating is run after installation of the IntaKlean Nano. We recommend that you check the radiators and air vents again to ensure that all air has been purged from the system.

## CLEANING AND SERVICING

We recommend that the IntaKlean Nano is serviced once every twelve months or in line with the servicing schedule of the boiler, or according to water conditions.

Prior to cleaning the IntaKlean Nano ensure that the working environment is safe.

Inta recommend that the boiler is turned off before commencing any maintenance works. Caution should also be taken regarding the temperature of the contents of the filter.

1. Isolate IntaKlean Nano from the system by shutting the isolating ball valve and other isolating valves to the boiler.
2. Place a suitable container underneath the filter and remove the drain cap.
3. Allow the filter contents to drain into the container and replace the drain cap.
4. Rotate the magnet to disengage it and allow it to be withdrawn.
5. Using a suitably sized spanner on the hexagon at the top of the transparent cap unscrew it and remove the filter cartridge.
6. Remove any residual debris from both the filter pot and transparent cap using a soft cloth or disposable paper towel and rinse in clean water.
7. Rinse the filter cartridge in clean water to remove any debris.
8. Re-assemble the filter and re-commission as detailed in the **COMMISSIONING** section of these instructions. Ensure that the **SERVICE SCHEDULE** is completed each time the filter is serviced.

9. Replace the 'O' ring cap seals if

damaged.

**WARNING - EXCESSIVE TIGHTENING OF THE CAP TO THE FILTER POT MAY IRREPARABLY DAMAGE THE FILTER.**

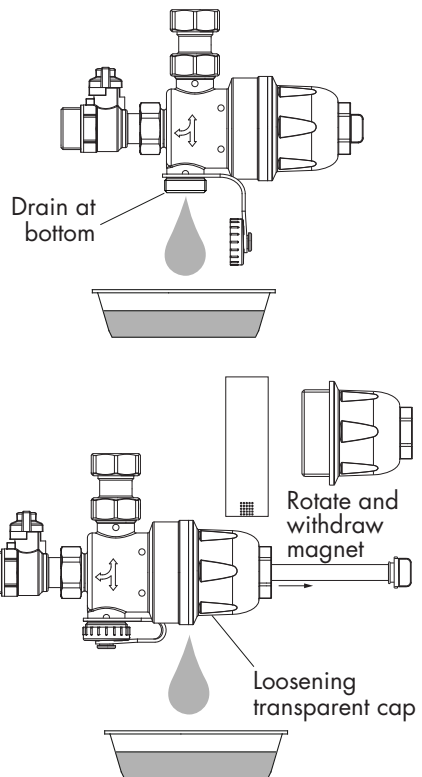

## CHEMICAL DOSING

To dose the system using the IntaKlean Nano, follow the below procedure;

1. The transparent cap must be in the horizontal position.
2. Ensure the working environment is safe and the boiler is turned off at the switch.
3. Isolate the IntaKlean Nano from the system by shutting other isolating valves to the boiler with Nano ball valve open.
4. Place a suitable container underneath the filter and remove the drain cap.
5. Allow the filter contents to drain into a container.
6. Connect a hose connector with a hose to the drain connection and add the dosing chemicals.
7. Allow the dosing chemical to flow into the main pipework system.
8. Repeat until the specified amount of chemicals have introduced in the system.
9. Re-commission the system as per the previous instructions in the **COMMISSIONING** section.

10. Complete the **SERVICE SCHEDULE** below..

## SERVICE SCHEDULE

| Service Number | Date | Attending engineer | Tick as appropriate     |                                 |                 |                       |
|----------------|------|--------------------|-------------------------|---------------------------------|-----------------|-----------------------|
|                |      |                    | Filter contents drained | Filter disassembled and cleaned | Inhibitor added | System cleanser added |
| 1              |      |                    |                         |                                 |                 |                       |
| 2              |      |                    |                         |                                 |                 |                       |
| 3              |      |                    |                         |                                 |                 |                       |
| 4              |      |                    |                         |                                 |                 |                       |
| 5              |      |                    |                         |                                 |                 |                       |
| 6              |      |                    |                         |                                 |                 |                       |
| 7              |      |                    |                         |                                 |                 |                       |
| 8              |      |                    |                         |                                 |                 |                       |
| 9              |      |                    |                         |                                 |                 |                       |
| 10             |      |                    |                         |                                 |                 |                       |

## **TECHNICAL SUPPORT & WARRANTY**

The IntaKlean Nano magnetic central heating system filter is covered by a two year warranty against manufacturing fault.

To register your product for warranty, please visit [www.intatec.co.uk](http://www.intatec.co.uk).

For technical assistance, please contact our dedicated technical support line on 01889 272 199.

Please Leave this Manual for the User

To activate your product warranty please visit

**[www.intatec.co.uk](http://www.intatec.co.uk)**

and click on Product Registration

# inta

**Intatec Ltd**

Airfield Industrial Estate

Hixon

Staffordshire

ST18 0PF

Tel: **01889 272 180**

Fax: **01889 272 181**

email: **[sales@intatec.co.uk](mailto:sales@intatec.co.uk)**

web: **[www.intatec.co.uk](http://www.intatec.co.uk)**