



- Paddle handles to aid users with limited dexterity
- Safe touch shower body
- Independent control of temperature and flow
- Thermostatic control with anti-scald cold water fail-safe technology
- WRAS & TMV3 Approved - Complies with NHS D08 & BS7942
- Wide range of suitable riser kits available
- Fast fix brackets



Product Range

Code	Description
ST10010CP	Acura TMV3 Safe Touch Thermostatic Bar Shower

Technical Features

Maximum Inlet Pressure (static):	5 Bar
Minimum Inlet Pressure (dynamic):	0.2 Bar
Maximum Inlet Temperature:	85°C
Factory Pre-set Temperature:	41°C with max temp stop
Temperature Stability:	±2°C
Maximum Inlet Pressure Ratio:	5:1
Minimum temperature differential between hot inlet and mixed outlet to achieve cold water failsafe:	10°C

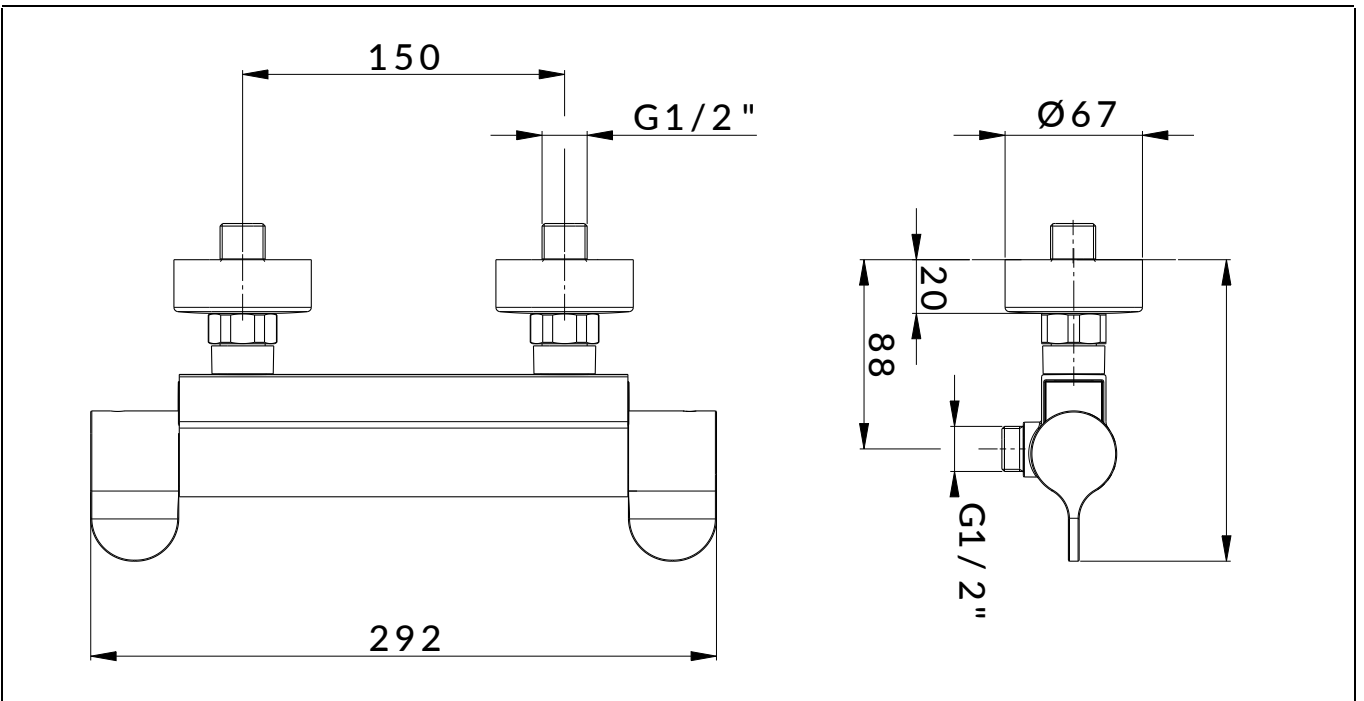

Application Diagrams

